



Internship - Creek Run L.L.C. Environmental Engineering

Jason Lenz

Department of Earth and Environmental Science, Taylor University, Upland, Indiana



Our mission is to serve our clients in a professional and dedicated manner by helping them to navigate the environmental regulatory process. We will practice strong environmental stewardship in our actions, in our thoughts and in our hearts. This mission is not one of activism but of caretaking for the environment within the regulatory process.



Creek Run Personnel

Services Offered Continued

Site Investigation Phase 1 Environmental Site Assessment



Property in Muncie, Indiana that Creek Run completed a Phase I Environmental Property Assessment

Phase 2 Environmental Site Assessment Subsurface Investigation

Probing with the Power Probe 9600E in Jonesboro, Indiana



Probing with the Power Probe 9600E in Hartford City, Indiana

Soil and Groundwater Remediation Remediation System Design Remedial Construction Management Remediation System Evaluation, Operation, and Maintenance



A remediation system located in Warsaw, Indiana

Regulatory Compliance Services Groundwater Monitoring Report Review and Regulatory Status Appraisal Site Mapping and Drafting Services

Project – Multiple Phase Extraction – Anderson, Indiana

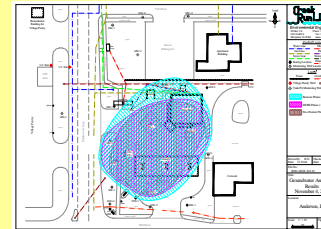

Free product, benzene, and MTBE plume delineation of site

MPE System Objectives

- Recovery of free product
- Removal of petroleum vapors in soil and impacted groundwater from the most heavily impacted areas
- Establishment of hydraulic control to prevent additional contaminant migration

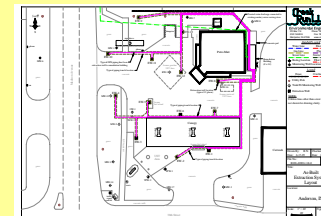

Final MPE system layout



Remediation system equipment building in operation since July 2005

- To date, the MPE system has removed:
- 35 gallons of free product
 - 431,764 gallons of impacted groundwater
 - Approximately 282 pounds of vapor-phase hydrocarbons

“Leading the way to a cleaner environment”



Montpelier, Indiana – The Heartland of America



Services Offered

- Tank Management
- UST Compliance Inspection
- UST Tightness Testing Coordination
- UST Closure – Tank Removal, Excavation Assessment, and Reporting
- UST Closure-in-Place
- UST System Design and Installation Coordination
- AST Installation Coordination
- Spill Prevention, Control, and Countermeasures (SPCC) Plans
- AST Removal and Bulk Plant Decommissioning



A UST Removal that took place in Fort Wayne, Indiana

Excess Liability Trust Fund
Excess Liability Trust Fund

Acknowledgments

I would like to thank my committee members: Dr. Edwin Squiers and Dr. Michael Guebert of Taylor University, Dr. Chris Worthman of DePaul University, and Jim Berndt of Mundell and Associates. I would also like to thank Leland Boren for providing the funding for this degree. A special note of appreciation to Jeff Miller for his hard work and dedication to our goals at Creek Run.

For further information

Please contact jlenz@creekrun.com. More information on this and related projects can be obtained at www.creekrun.com.

